

1/8 Pocher Rolls Royce (Pocher) Distributor / Ignition Coil / Cable Management Upgrade Kit



Thank you for purchasing this upgrade kit for the 1/8 Pocher Rolls Royce.

Please note the following:

- Some parts will need final finishing / filing / sanding to removing printing 'nubs'.
- After preparing the parts they can be washed in warm soapy water and allowed to dry.
 - Use of super-glue is preferred for attaching resin parts.
 - Test fit into the model before final attachment.

If you have any questions regarding this kit or any other feedback, suggestions or to be updated on future releases for this model please feel free to contact us at:

modelparts1@outlook.com

Ignition Coil Assembly -

- 1 x Canister - Main Body
- 1 x Canister Cap
- 1 x Canister Base
- 2 x Knurled Knobs (box "H")
- 1 x Terminal Block - (box "I")
- 2 x Eye Terminals - (box "A")

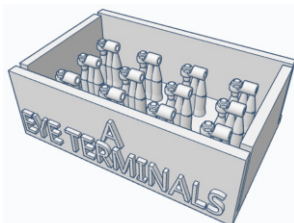
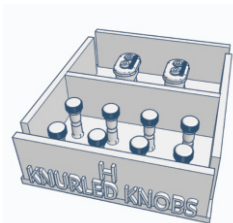

Replaces Pocher Part 72601-20

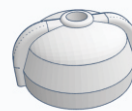

Replaces Pocher Part 72602-20

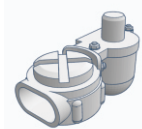

Replaces Pocher Part 72601-20

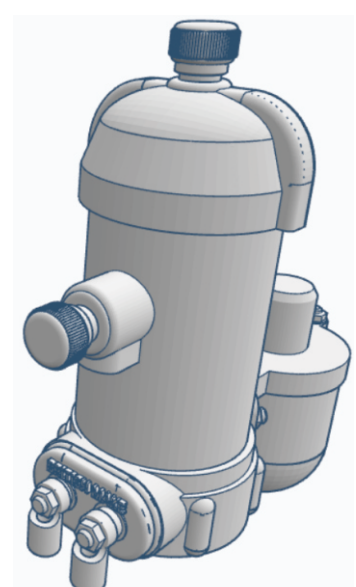
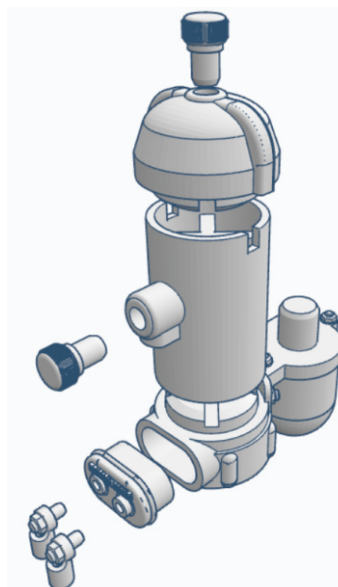
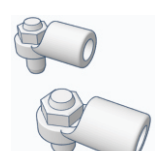
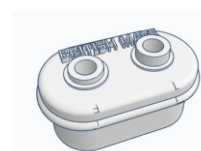

Distributor Assembly -

- 1 x Distributor Base
- 1 x Distributor Cap
- 7 x Distributor Cap Screws (box "F")
- 2 x Clamps
- 2 x Clamp Studs (box "D")
- 1 x Eye Terminal - (box "A")

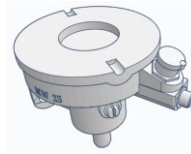
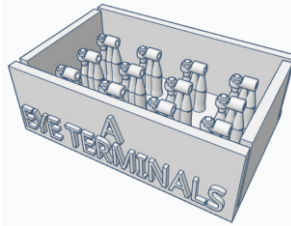
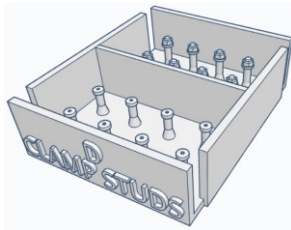
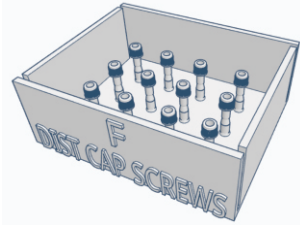

Replaces Pocher
Part 72704-25

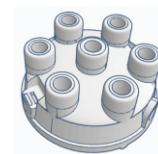

Replaces Pocher
Part 72630-20

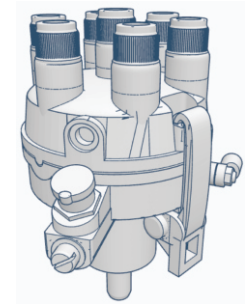
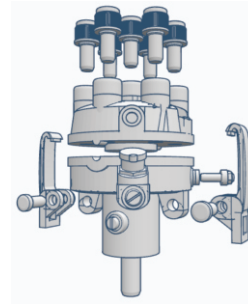
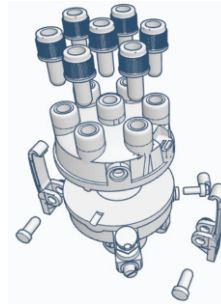
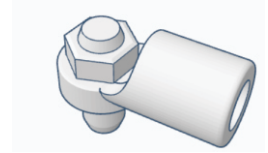
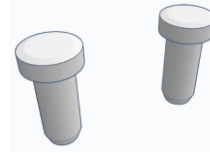
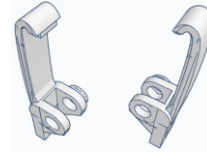

Notes: Ensure correct orientation of the top housing to the bottom housing.

Use tweezers to insert the clamp pins through the clamp and lower housing holes. The clamps will move freely and can then clamp the top section.

Use rubber cord provided to replicate the spark plug cables

Ignition Lead / Cable Management -

- 1 x Cable Tube - Long - Inlet Side
- 1 x Cable Tube - Short - Exhaust Side
- 1 x Elbow Cable Tube - Inlet Side
- 8 x Tube Bolts (box "E")
- 12 x Wing Nuts (box "B") (optional)
- 12 x Thumb Screws (box "C") (optional)
- 12x Plug Terminals (box "G")

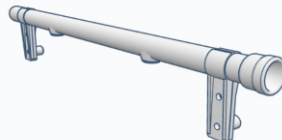
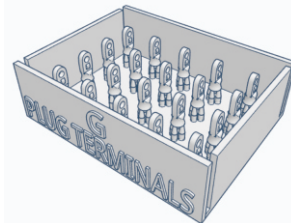
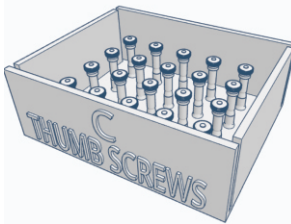
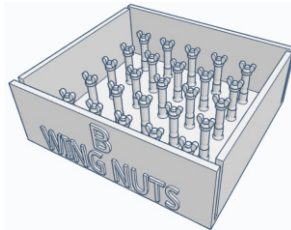
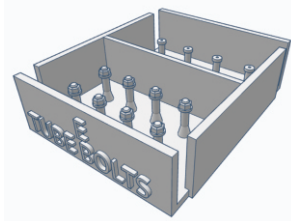

Replaces Pocher
Part 72165-08-0

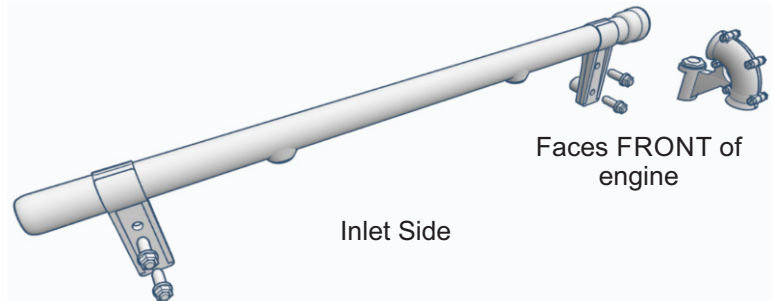
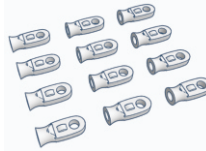
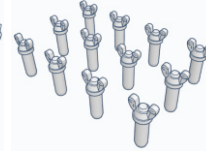
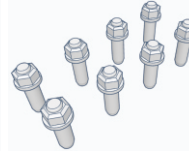
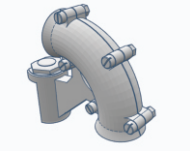
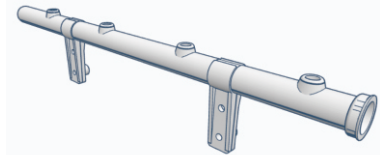

The RECESSED mounting points of the tubes are designed to align with the points on the Pocher kit part. The Pocher kit only allows for a single mounting bolt at each end however 2 bolts on each end is more correct, this is simulated on this part.

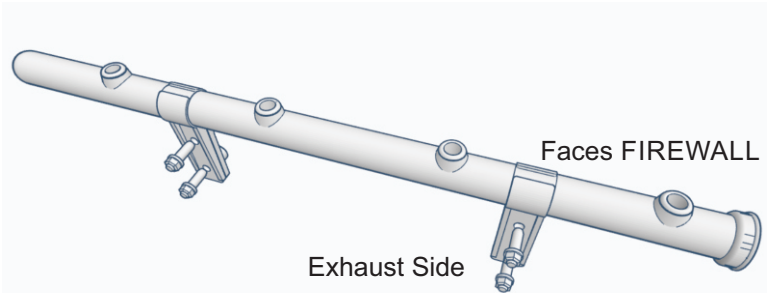

To ease construction, the tubes are not designed to have the "spark plug leads" run through, but have enough openings to cut the leads and insert to simulate the complete cable. Refer to reference pics for how the cable is to be run.

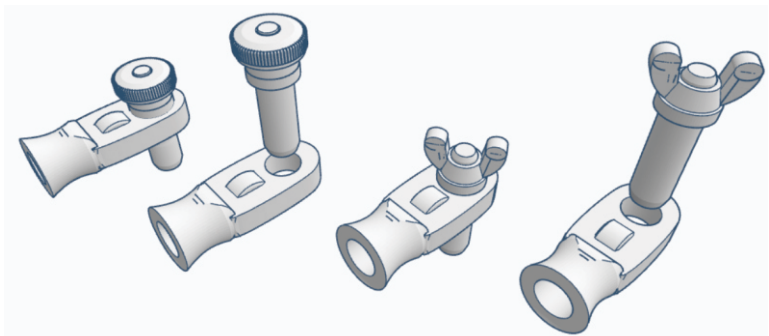

Optional Thumb Screws or Wingnuts - x 12 of either "Spark Plug Leads" insert into the opening of the Terminals, the stud of the Thumbscrews or Wingnuts inserts into the Pocher Kit Spark Plug openings on the engine block.